



# SO-1280

**REF** SO1280WR70

This SO-1280 battery is primary, non-rechargeable lithium sulphur dioxide, engineered and designed for use in a world wide tactical environment, and is manufactured to meet and exceed Indian military standard JSS-55555 and ISO-9000 methods and procedures. This battery meets the requirements of JSS 6135-01:2013 and MIL-PRF-49471B with reference to MIL-STD-810E.

## Key Features

- Standard power battery, 120Wh
- Robust molded plastic case
- Non-replaceable 3A fuse at ground
- High temperature thermal fuse at ground
- Diode at 15 V positive output

## Typical Applications

- STAR V, 5W MK-I, RADIO SET
- Surveillance equipment
- Remote control electronics
- Portable Manpack Power bank
- Rugged portable electronics

**Non-Rechargeable Battery  
Lithium Sulphur Dioxide  
15V 8.0Ah, 120Wh**

## Compliance

- JSS-55555
- JSS-6135-01 : 2013
- MIL-STD-810E
- MIL-PRF-49471B

## Approvals

- ISO 9001:2015
- ISO 13485:2016
- Safety Datasheet
- IS 16046 : 2018 (cells)

## Technical Specification:-

Part Number	SO-1280
Pack Designation	5WR34/63-1
Capacity (typ.)	8.0 AH
Nominal Voltage	15.0 V
Maximum Voltage	15.25 V
Operating voltage	12.0 V
Cut-off voltage	10.0 V
Max. Discharge Current (cont.)	1.0 A
Max. Discharge Current (pulse)	3.0 A for 10 sec.
CAT P/N:	Y3/6135-000287
Life Cycle	Primary battery, one-time use
Drawing	CQAL 4414
Shelf Life	3 years
<b>Physical Characteristics</b>	
Dimensions (L x W x H)	259 x 89.0 x 117.0 mm
Weight	1.2 Kg ± 0.1 Kg
Weight energy density	100 Wh/Kg
Connector	2-Way Female Floating Socket
Battery Housing	Plastic UL94V-0
Color	Olive drab / Black





# Lithium Sulphur Dioxide 15V 8.0Ah, 120Wh

Mid-discharge voltage vs. rate at various temperatures

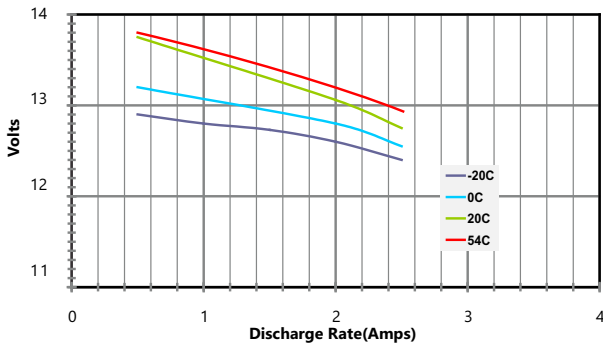

2 A discharge typical curves at various temperatures

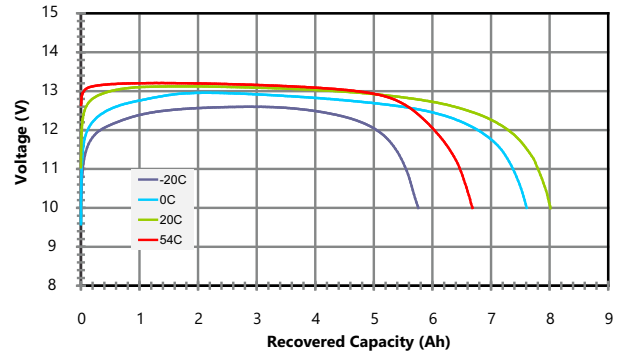

**Operating Temperature**

- Discharge -20°C to +55°C

**Storage**

- Allowable: -20 to +55°C
- Recommended: +20 to +40°C
- Humidity at 0 to 95%

**Transportation**

- Miscellaneous Class 9

**Further Information**

Please refer to our website [www.sesbatteries.co](http://www.sesbatteries.co) for a complete range of useful downloads, such as product catalogs, material safety data sheets (MSDS), ISO certification, etc.

Capacity vs. rate at various temperatures

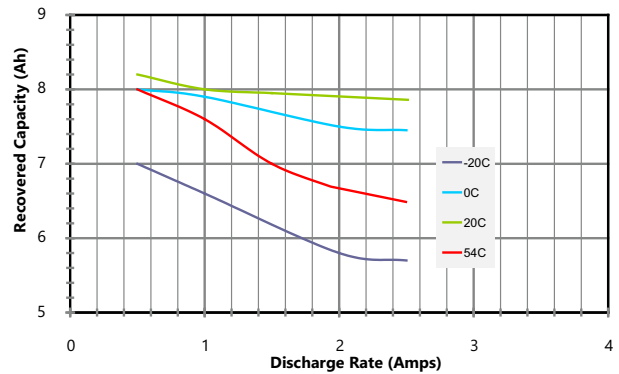

**Product Dimension**

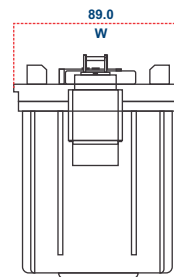
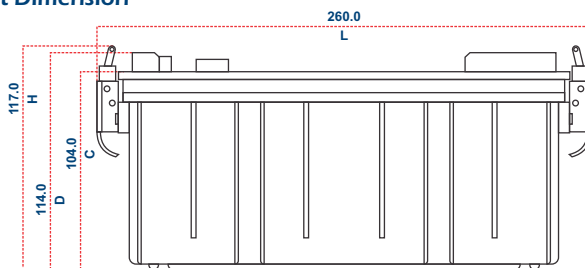

Dimensions are in Millimeters  
Tolerances: ±0.5mm

L : 260.0	W : 89.0
H : 117	A : 224.0
B : 236.0	C : 104.0
D : 114.0	

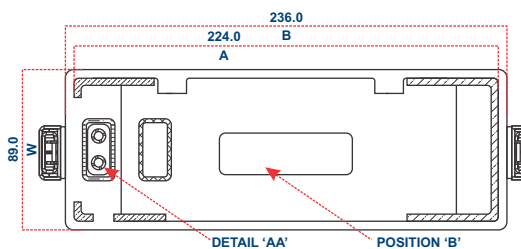

Li-SO<sub>2</sub>

